

PART OF THE NORTHEAST QUARTER OF SECTION 16,
TOWNSHIP 17 NORTH, RANGE 17 EAST, W.M.



LEGEND

- SET 5/8" REBAR W/ CAP
— "CRUSE 36815"
- FOUND PIN & CAP
- x— FENCE

NOTES:

1. THIS SURVEY WAS PERFORMED USING A TOPCON GTS SERIES TOTAL STATION. THE CONTROLLING MONUMENTS AND PROPERTY CORNERS SHOWN HEREON WERE LOCATED, STAKED AND CHECKED FROM A CLOSED FIELD TRAVERSE IN EXCESS OF 1:10,000 LINEAR CLOSURE AFTER AZIMUTH ADJUSTMENT.
2. THIS SURVEY MAY NOT SHOW ALL EASEMENTS OR IMPROVEMENTS WHICH MAY PERTAIN TO THIS PROPERTY.
3. THE DEED RECORDED UNDER AFN 201408050029 DOES NOT EXCEPT OUT THE RIGHT OF WAY OF MANASTASH ROAD.
4. THE DEED RECORDED UNDER AFN 201408050025 CALLS 500' ALONG THE SOUTH BOUNDARY OF MANASTASH COUNTY ROAD AND 500' EAST OF THE WESTERLY BOUNDARY LINE OF THE W 1/2 OF THE NE 1/4. I HELD THE 500' ALONG MANASTASH COUNTY ROAD FOR THIS SURVEY.
5. THE PURPOSE OF THIS SURVEY IS A BOUNDARY LINE ADJUSTMENT.

AUDITOR'S CERTIFICATE

Filed for record this _____ day of _____
2017, at _____ M., in Book 40 of Surveys at
page(s) _____ at the request of Cruse & Associates.

JERALD V. PETTIT BY: _____
KITITAS COUNTY AUDITOR

SURVEYOR'S CERTIFICATE

This map correctly represents a survey made by
me or under my direction in conformance with
the requirements of the Survey Recording Act
at the request of STEPHEN CROWLEY
in SEPTEMBER of 2016.

PRELIMINARY ONLY

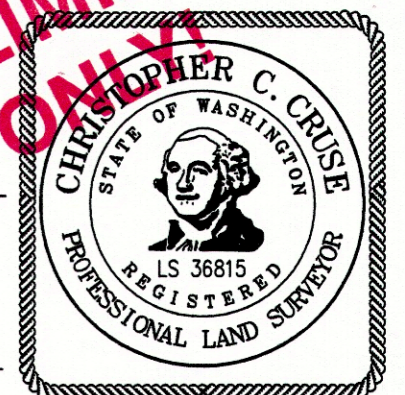

CHRISTOPHER C. CRUSE
Professional Land Surveyor
License No. 36815

DATE

CRUSE & ASSOCIATES

PROFESSIONAL LAND SURVEYORS
217 East Fourth Street P.O. Box 959
Ellensburg, WA 98926 (509) 962-8242

CROWLEY PROPERTY

LEGAL DESCRIPTIONS

EXISTING PARCEL DESCRIPTIONS - AFN 201408050025 &
AFN 201408050029

NEW DESCRIPTIONS

PARCEL A

PARCEL A OF THAT CERTAIN SURVEY RECORDED FEBRUARY
____, 2017, IN BOOK 40 OF SURVEYS AT PAGES _____
UNDER AUDITOR'S FILE NO. 201702 _____ RECORDS OF
KITITAS COUNTY, WASHINGTON; BEING A PORTION OF THE
NORTHEAST QUARTER OF SECTION 16, TOWNSHIP 17 NORTH,
RANGE 17 EAST, W.M., IN THE COUNTY OF KITITAS, STATE
OF WASHINGTON.

PARCEL B

PARCEL B OF THAT CERTAIN SURVEY RECORDED FEBRUARY
____, 2017, IN BOOK 40 OF SURVEYS AT PAGES _____
UNDER AUDITOR'S FILE NO. 201702 _____ RECORDS OF
KITITAS COUNTY, WASHINGTON; BEING A PORTION OF THE
NORTHEAST QUARTER OF SECTION 16, TOWNSHIP 17 NORTH,
RANGE 17 EAST, W.M., IN THE COUNTY OF KITITAS, STATE
OF WASHINGTON.

LINE	BEARING	DISTANCE
L1	S 74°16'09" W	199.50'
L2	S 79°08'50" W	213.38'
L3	S 75°04'20" W	213.33'
L4	N 75°04'20" E	229.60'
L5	N 79°08'50" E	211.25'
L6	N 74°16'09" E	198.52'
L7	S 75°18'38" W	43.82'
L8	N 26°09'01" W	140.16'
L9	S 66°33'21" W	90.41'
L10	S 89°14'30" W	49.23'
L11	N 55°59'57" W	114.49'
L12	S 42°39'47" W	52.35'
L13	S 23°36'51" W	73.93'
L14	N 63°32'09" W	91.98'
L15	S 87°05'10" W	89.61'
L16	N 75°32'15" W	120.24'
L19	S 58°49'26" W	80.99'
L20	N 87°08'43" W	129.72'

(BASIS OF BEARINGS = BK 39 OF SURVEYS, PG 60
ALONG THE E BDY OF NE1/4 - S 02°12'13" W
S 02°12'13" W

GRAPHIC SCALE

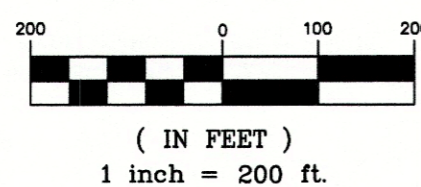

E 1/2 NE1/4

W 1/2 NE1/4

	X
	X

